

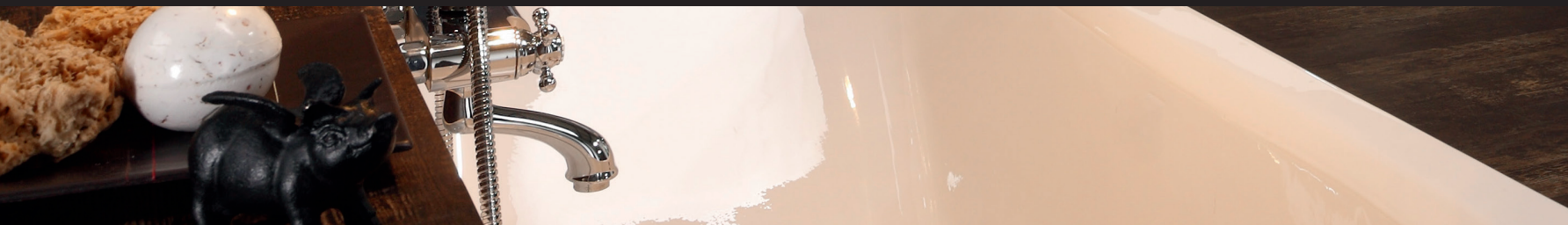

Brief instructions

ebios-fire - The City - wick burner



FOREWORD / QUALITY PHILOSOPHY

You have decided in favour of a SPARTHERM ebios-fire - thank you for your confidence in our company.

In a world of excess and mass production, our company stands for the values expressed by our owner Gerhard Manfred Rokossa:

„High technical quality combined with contemporary design and a customer service which ensures not only utmost satisfaction but also that we are recommended.“

Together with our specialist partners, we offer first-class products which will touch your emotions and evoke a sense of security and comfort. To achieve this, we recommend that you read the operating instructions carefully in order to get a quick and comprehensive overview of your decorative fireplace.

In addition to information on use, these instructions also include important details on care and operation to guarantee your safety and the maintenance of your ebios-fire as well as useful tips and guidance.

For further enquiries, please contact your specialist dealer.

We hope you enjoy your new fireplace.

Your SPARTHERM Team
G.M. Rokossa



CONTENTS

Important note	4
1. Scope of delivery	4
2. Fire protection	5
3. Commissioning	5
4. Taking out of operation	7
5. General warranty conditions	7
5.1 Area of application	7
5.2 General information	7
5.3 Warranty period	7
5.4 Requirements for this warranty to be effective	8
5.5 Exclusion of warranty	8
5.6 Elimination of defects / repair	8
5.7 Extension of the warranty period	8
5.8 Spare parts	8
5.9 Liability	9
5.10 Final comments	9

IMPORTANT NOTE

As per the German Equipment and Product Safety Act (GPSG) and our statutory duty to notify, we would like to inform you about heating with this product.

The calorific value of 96% ethanol equates to approx. 29,600 kJ / kg. With fuel consumption of 0.5 l/h the heat released is approx. 3,300 W.

The decorative fireplace requires a plentiful supply of fresh air when operated as otherwise the amount of carbon dioxide created exceeds the permitted concentration in the room air.

As a rule, the fresh air supplied is cooler than the room air to be heated up which results in a loss of heat. The effective heat output of a biofuel fireplace is thus very low and, as such, decorative fireplaces which use biofuel are not sources of heat.

These are only decorative fireplaces and are not intended for heating or continuous operation. Nevertheless, please note that heat is generated as a by-product of the combustion process. This can cause increased heating in the room where the fireplace is installed. Please read the safety instructions carefully.

PLEASE DO NOT USE BIO-ETHANOL WITH A PURITY LEVEL IN EXCESS OF 97%.

1. SCOPE OF DELIVERY

ebios-fire with the following features:

- Housing
- 1 burner made of stainless steel
- 1 burner mat made of Ceramat FN
- Safety container for every burner, made of stainless steel
- Cover plate (with recess for the grab handle) made of stainless steel
- Bottle for moistening the burner mat
- Tank seal with gasket
- Fill level indicator
- Key for opening and closing the tank cover
- Cold hand for lifting and uncovering the cover plate
- Funnel for filling the burner
- Stick lighter
- Type plate (on the front of the burner)
- Ethanol 5 litre canister with outlet valve for initial commissioning (only within Germany)
- Supplied pre-assembled in transport-friendly disposable cardboard packaging

2. FIRE PROTECTION

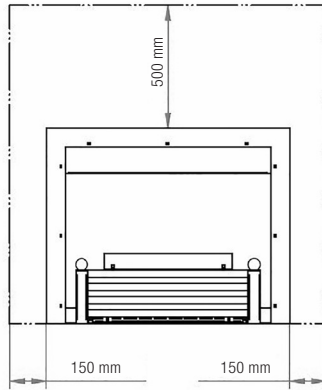

Distance from combustible components

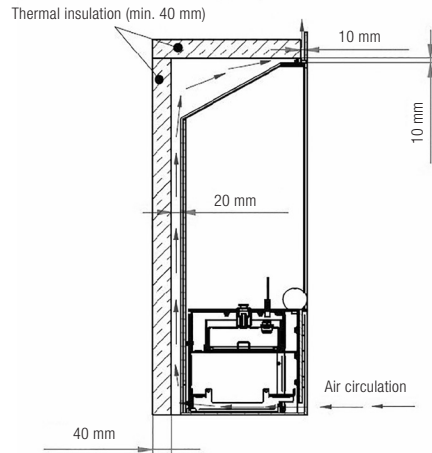

Installation specification and insulation measures

3. COMMISSIONING

Proceed as follows:

1. Ensure that there is a sufficient supply of air.
2. Make sure that the burner has gone out and has cooled down fully (minimum waiting time after being extinguished = 1 hour).
3. The burner can remain in the housing when being refilled. For this purpose, open the tank cover. Depending on the installation situation, it may prove necessary to remove the glass safety panes.
4. Check the tank contents.
5. Make sure that the cover plate is placed on the burner and covers the burner mat.
6. Use a wrench to open the filling screw.



7. Insert the funnel into the filling opening and pour in a maximum of 2.6 litres of bioethanol.

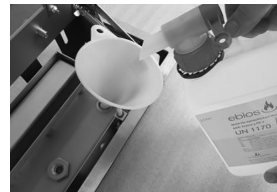

8. The fill level indicator shows the maximum permitted fill level.



The maximum fill level is reached once the red ball rises to the top.

9. Pick up the bottle to wet the burner. Insert the bottle with the opening into the tank opening so that it projects into the fuel. Press the bottle together so that the air escapes and the fuel is sucked up when it is released. Wait until the bottle returns to its original shape.



10. Seal the filling plug securely using the wrench.



11. Close the housing cover, ensure that the cover does not project into the flames but remains a uniform distance from the burner channel. Then insert the protective panes.
12. Insert the cold hand to grip the cover plate and lift it off.



13. Wet the burner mat with fuel using the bottle which has just been filled.

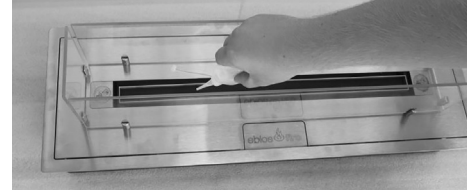

14. Put the bottle down to one side.
15. Wait approx. 2 minutes before igniting the fire to allow the wick to be fully saturated with ethanol.
16. Ignite the fire on the burner mat and step back from the flames. It may take a few minutes until uniform flames appear.

Should you ever pour in too much fuel and cause the burner to overflow, the ethanol collects in the safety container. Empty this immediately and before lighting the burner. Clean the surface of the burner until it is dry and completely free of ethanol.

Caution: Ethanol is highly combustible. There must be no sources of ignition in the vicinity!

4. TAKING OUT OF OPERATION

If you wish to take the burner out of operation at an earlier stage than normal, place the cover on the burner with the aid of the 'cold hand'. Insert the 'cold hand' to grip the cover plate and then cover this over the burner channel.

5. GENERAL WARRANTY CONDITIONS

5.1 AREA OF APPLICATION

These standard warranty terms apply for the contractual relationship between the manufacturer, Spartherm Feuerungstechnik GmbH, and the dealer/distributor. They are not congruent with the contractual and warranty terms which the dealer/distributor offers his customers in individual cases.

5.2 GENERAL INFORMATION

This product has been manufactured in compliance with current standards of quality control. The materials used have been carefully selected and - like the production process - are subject to on-going quality control.

Specialist knowledge is required when assembling and installing the product. The product must, therefore, only be installed and commissioned into service by specialist technical staff, in compliance with current statutory provisions.

5.3 WARRANTY PERIOD

The standard warranty terms only apply within Germany and the European Union. The warranty period and scope of the warranty are ensured within the framework of these conditions outside the statutory warranty which remains unaffected.

Spartherm Feuerungstechnik GmbH grants a 24-month warranty on ebios-fire devices (Solitaire and inserts)

Spartherm Feuerungstechnik GmbH grants a 6-month warranty on wearing parts in the fire area, e.g., wicks, burner mats, seals and glass ceramic.

5.4 REQUIREMENTS FOR THIS WARRANTY TO BE EFFECTIVE

The warranty period shall begin on the date, on which the product is delivered to the dealer / distributor. Invoices or delivery notes may be used as confirmation of the warranty commencement date. The warranty certificate for the product must be presented by the claimant upon making a warranty claim. Spartherm Feuerungstechnik GmbH is not obliged to satisfy any claim if such documentation is not presented.

5.5 EXCLUSION OF WARRANTY

This warranty does not cover:

- component wear
Wick/burner mat due to thermal stress
- the fireplace surfaces:
Discolouration of the finish or on the galvanic surfaces of the furniture and/or burner which are a result of thermal stresses or overloading
- the glass panes:
contamination, due to soot or other burnt-on combustion materials and visual deterioration due to thermal loading.
- Use of unsuitable or non-designated fuel.
- We recommend bioethanol from Spartherm Feuerungstechnik GmbH with a concentration in excess of 96% for your ebios-fire device.
- incorrect transportation and/or incorrect storage:
- inappropriate or careless handling of fragile components, such as glass or ceramics
- improper operation and/or use
- incorrect filling of system
- lack of maintenance
- incorrect set-up/installation of device
- failure to comply with Installation and Operating Manual
- technical modifications made to the appliance by third parties

5.6 ELIMINATION OF DEFECTS / REPAIR

Independent of any statutory provisions acknowledged as taking precedence over the terms of this warranty, all necessary repair works resulting from material or manufacturing defect shall be carried out free-of-charge and shall not invalidate the remaining provisions of the warranty.

Within the scope of this warranty promise Spartherm Feuerungstechnik GmbH reserves the right to either remedy the fault or replace the device free of charge. The elimination of defects shall take precedence.

The terms of this warranty shall not extend to any damage or compensation not covered by statutory provisions.

5.7 EXTENSION OF THE WARRANTY PERIOD

The warranty period shall automatically be extended, where claims made in respect of these warranty provisions result in the repair or replacement of defective equipment.

5.8 SPARE PARTS

Only the manufacturer's own components, or replacement parts recommended and approved by the manufacturer, shall be used for appliance servicing and repair.

5.9 LIABILITY

Damages and claims for compensation which are not the result of delivery of a defective appliance from Spartherm Feuerungstechnik GmbH are excluded and are not part of this warranty promise.

The above shall not include claims made in respect of statutory legal requirements.

5.10 FINAL COMMENTS

In addition to these warranty conditions and our commitment to them, our dealers and contractual partners are pledged to assist you in both word and deed.

It is expressly recommended to have ebios-fire products checked regularly by a stove fitter/specialist dealer.

We reserve the right to make alterations to the technical data contained herein and accept no liability in respect of any errors made.



SPARTHERM

DIE WELTMARKE FÜR IHR WOHNZIMMER

The Global brand for your living room | La référence mondiale pour votre salon | Il marchio mondiale per il vostro soggiorno

La marca mundial para su salón | Het merk van wereldformaat voor uw woonkamer | Światowa marka do Państwa salonu

Торговая марка № 1 для Вашего дома

D Ihr Fachhändler | UK Your specialist dealer | F Votre revendeur spécialisé
IT Il vostro rivenditore specializzato | E Sus comercios especializados
NL Uw vakhandelaar | PL Państwa sprzedawca | РУС Ваш дилер



Spartherm Feuerungstechnik GmbH · Maschweg 38 · D-49324 Melle
Phone +49 (0) 5422 94 41-0 · Fax +49 (0) 5422 9441-14 · www.spartherm.com